

PARAMETER	SYMBOL	VALUE	UNIT
Reverse Voltage	V_r	2.0	V
Operating Temperature	T_{op}	+10~+30	°C
Storage Temperature	T_{stg}	-20 ~ +80	°C
Lead soldering temperature (10 sec.)	T_{is}	260	°C

Features:

- 1450nm
- High coupling efficiency
- Multi mode fiber pigtail
- 4-pin HHL package
- Air cooling(heat-sink)

Applications:

- Medical laser treatment



Specifications

WSLX-1450-300m-M

	Mini	Type	Max
Center Wavelength@25°C	----	1450±40nm	----
Spectral Width (FWHM)		----	3nm
Output Power		330mW	400mW
Temperature Coefficient of Wavelength		0.3nm / °C	
Threshold Current (Typ.)		57mA	
Operating Current (Typ.)		2.5A	
Operating Voltage		1.76V	
Recommended Case Temperature		25°C	
TEC Max. Current		----	
TEC Max. Voltage		----	
Fiber Core Diameter	200um		
Fiber Numerical Aperture	0.22		
Fiber Length	100cm		
Connector Type	SMA905/ST/FC		
Package Style	4-pin HHL air cooling		



2M Lasers

4-pin HHL Package View

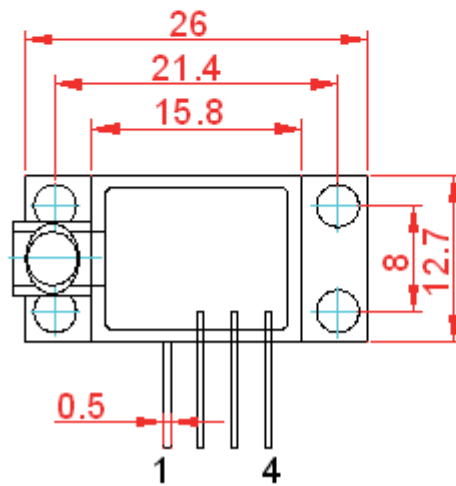
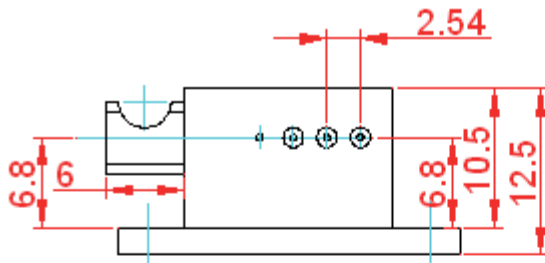

1. Laser Anode (+)
2. Laser Cathode(-)
3. None
4. None

**Electrically shorten LD module and store in non-extreme conditions.
Suggest using the constant current power supply.**